

Option: Tuchleitschale

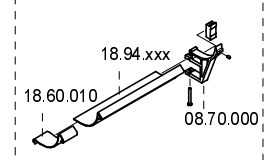

- 76.50.350 (ø78)
- 76.50.450 (ø85)
- 02.40.000
- 74.91.010
- 74.90.520

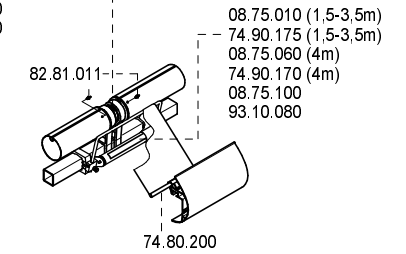

- 08.75.010 (1,5-3,5m)
- 74.90.175 (1,5-3,5m)
- 08.75.060 (4m)
- 74.90.170 (4m)
- 08.75.100
- 93.10.080

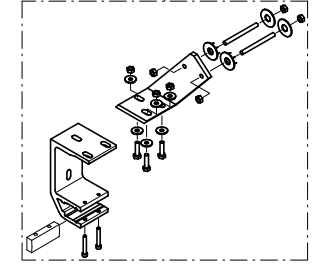
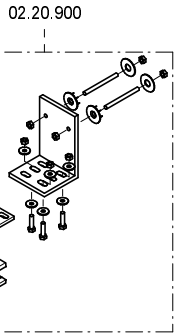

- 02.20.920 (L)
- 02.20.910 (R)

- 72.33.xxx(ø78)
- 72.34.xxx(ø85)
- 93.10.100(weiss)
- 93.10.110(schwarz)

- 76.10.120(ø78)
- 76.10.130(ø85)

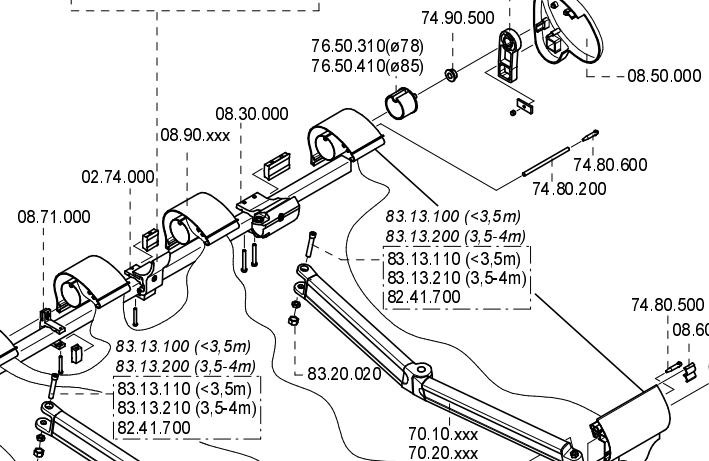

- 83.13.100 (<3,5m)
- 83.13.200 (3,5-4m)
- 83.13.110 (<3,5m)
- 83.13.210 (3,5-4m)
- 82.41.700

- 74.80.500
- 08.60.000
- 08.51.000

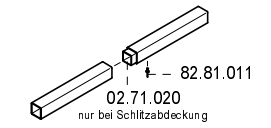

nur bei Schlitzabdeckung  
02.71.020

- 02.40.000
- 82.82.400
- 82.37.412

- mit Kurbel
- 76.20.110 (800)
  - 76.20.120 (1000)
  - 76.20.130 (1200)
  - 76.20.140 (1400)
  - 76.20.150 (1600)
  - 76.20.160 (1800)
  - 76.20.180 (sonder)

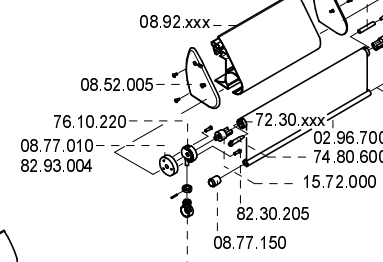
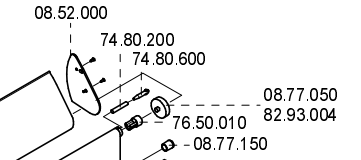
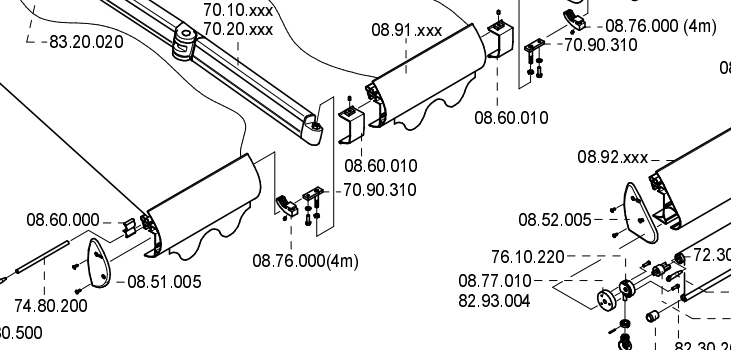
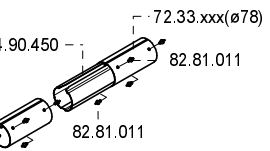
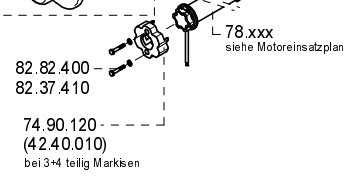

- mit Kurbel
- 76.20.110 (800)
  - 76.20.120 (1000)
  - 76.20.130 (1200)
  - 76.20.140 (1400)
  - 76.20.150 (1600)
  - 76.20.160 (1800)
  - 76.20.180 (sonder)

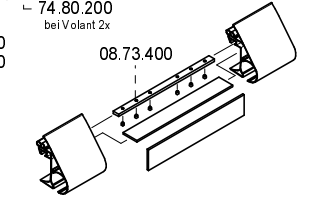

Die Liefermenge ist abhängig von der gewählten Motorleistung. Die Motorleistung ist in der Motorleistungsangabe angegeben. Die Motorleistung ist in der Motorleistungsangabe angegeben.

Preisgruppe	Motorleistung	Teil-Nr./Beschreibung	Teil-Nr./Beschreibung
G250	500 bis 1800	08.73.400	Halbkassettenspannrolle
Varisol			1,7
		VARISOL	Beschreibung
		G250 Basismarkise	
		Halbkassettenspannrolle	
		003264	Version-Nr. 9
1.000	1.000	1.000	1.000